

**VSD36,VSD42,VSD48**

**ASSEMBLY INSTRUCTIONS**

**Getting started:**

Prepare a solid surface with protection layer to assemble on.

STEP 1: Join side panel with back panel.

STEP 2: Join bottom panel with side panel.

STEP 3: Join side panel with bottom and back panel.

STEP 4: Attach face-frame and toekick board.

STEP 5: Join the drawers together, then install the drawer guide.

STEP 6: Attach the wooden corner blocks on the top corners, then put in the adjustable shelves.

STEP 7: Fix drawer heads on the drawer fronts and fix doors onto the face-frame and adjust the cover-space.

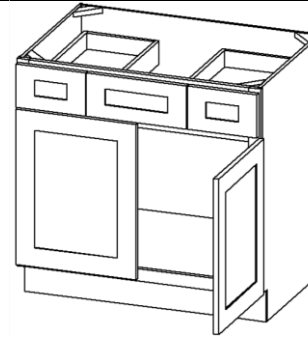

PARTS LIST		
NO.	Description	QTY
1	FACE FRAME	1
2	DRAWER BOX BOTTOM	2
3	DRAWER BOX SIDE	4
4	DRAWER BOX FRONT AND BACK	4
5	BACK PANEL	1
6	TOP&BOTTOM PANEL	1
7	SIDE PANEL	2
8	TOE KICK	1
9	CABINETS DOOR	2
10	DRAWER HEAD	1
11	DRAWER HEAD	2

11	1 1/2" SOFTCLOSE HINGE	4	
10	3/4" ROUND HEAD SCREW	4	
9	BUMPER	12	
8	DAMPER	2	
7	1" ROUND HEAD SCREW	8	
6	Selfclose slider	2	
5	9/16" ROUND HEAD SCREW	55	
4	CLEAT AND BUCKLE	11	
3	1" FLAT HEAD SCREW FOR CARCASS	5	
2	WOOD BLOCK	4	
1	1" FLAT HEAD SCREW FOR WOOD BLOCK	8	

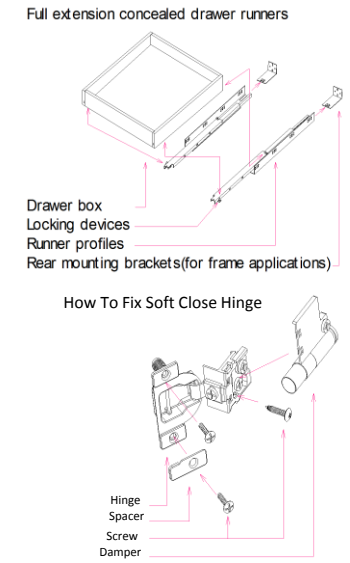
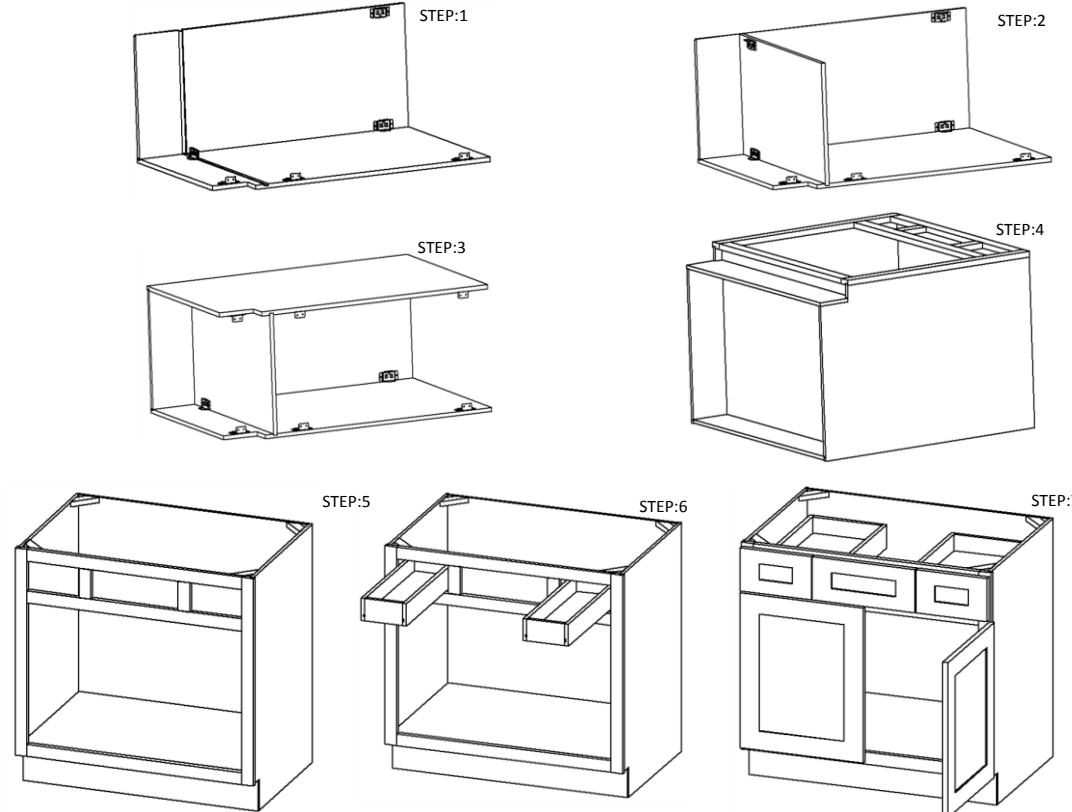

NO.	Description	QTY	PICTURE
HARDWARE LIST			